



FHA

### Benefits

- Extremely high efficiency of heat transfer
- Extremely low internal volume of the circuit
- Low noise level and energy consumption
- Reduced dehumidification of the cold room
- Reduced frost formation
- Low-silhouette for efficient use of cold room space
- Two-year product guarantee

### General information & application

FHA is the range of commercial low-silhouette unit coolers from LU-VE Exchangers, for optimal conservation of fresh and frozen goods.

Refrigerants



Capacity range (SC2 with R404)  
Air quantity

850 up to 6,100 W  
550 up to 3,000 m<sup>3</sup>/h

### Coil

The very high-efficiency TURBOCOIL® 2 heat exchangers have the best power/cost ratio obtainable.

- High-efficiency aluminium fins (TURBOFIN®2) with special turbulator profile to reduce dehumidification and frost formation.
- Small diameter, high-efficiency copper tubes with inner helical grooving, specifically designed for the new refrigerants.

Standard fin spacings 3, 4.5 and 7 mm.

### Casing

Newly designed, highly resistant casing in reinforced synthetic "Safeshell" material. Casing shape designed to minimize damages caused by accidental impact.

### Fan motors

1 to 4 fans fitted with AC or EC motors blowing through the coil. Fan Ø 275 mm. Power supply 230/1/50-60. Fan motors wired to connection box.

### Design pressure

Refrigerant	Max working pressure
HFC*	24 bar
CO <sub>2</sub>	60 bar**

\* Fluid group 2 according to EN 378; \*\* 85 bar in special execution

Each heat exchanger is leak tested with dry air and finally supplied with a dry air pre-charge.

Fitted with schröder valve on the suction connection for testing purposes.

### Options

- Electric defrost.  
The stainless steel defrost elements are connected to dedicated terminal box.
- Driptray heater.
- Corrosion protection: precoated aluminium fins.

### Selection

Selection and pricing is to be performed with our air heat exchanger selection software Refriger.

Selection output includes all relevant technical data and dimensional drawings.



### Certifications

The LU-VE Exchangers quality system is in accordance with ISO 9001. All products are manufactured according to PED regulations. LU-VE Group participates in the ECP program for HE. Check ongoing validity of certificate: [www.eurovent-certification.com](http://www.eurovent-certification.com)

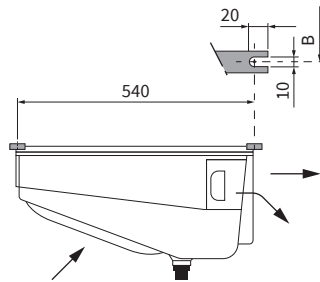

### Dimensions

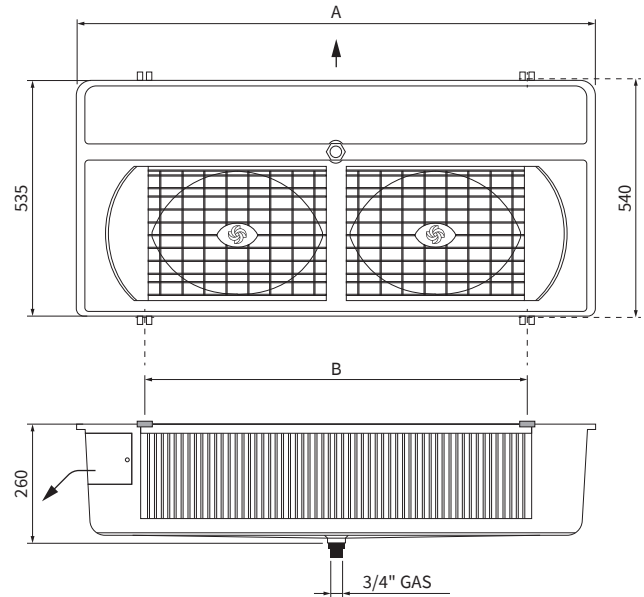

Model	No. fans	Fin spacing (mm)	Capacity*	Capacity SC2	Air quantity (m <sup>3</sup> /h)	Air throw (m)	Circuit volume (dm <sup>3</sup> )	A (mm)	B (mm)
30-32	1	3.0	1650	1200	550	8	0,6	605	293
40-32	1	3.0	2050	1500	650	8	0,9	730	418
60-32	2	3.0	3350	2470	1100	9	1,2	920	618
80-32	2	3.0	4150	3050	1300	9	1,7	1070	868
120-32	3	3.0	6300	4650	1950	10	2,5	1630	1318
160-32	4	3.0	8250	6100	2600	11	3,2	2080	1768
21-50	1	4.5	1450	1050	600	9	0,6	605	293
27-50	1	4.5	1800	1350	720	9	0,9	730	418
41-50	2	4.5	2950	2180	1200	10	1,2	920	618
53-50	2	4.5	3600	2660	1440	10	1,7	1070	868
79-50	3	4.5	5500	4050	2160	11	2,5	1630	1318
106-50	4	4.5	7350	5450	2880	12	3,2	2080	1768
14-80	1	7.0	1130	850	670	10	0,6	605	293
17-80	1	7.0	1370	1000	750	10	0,9	730	418
28-80	2	7.0	2270	1680	1340	11	1,2	920	618
35-80	2	7.0	2730	2010	1500	11	1,7	1070	868
52-80	3	7.0	4260	3150	2250	12	2,5	1630	1318
70-80	4	7.0	5730	4250	3000	13	3,2	2080	1768

\* Fluid R404A, TC =2.5 °C ΔT 1= 10 K

31639111EN-00

LU-VE Exchangers is a trademark registered and owned by LU-VE Group.  
LU-VE Exchangers reserves the right to change specifications without prior notification.

